

Connect Your Accu-Chek® SmartGuide to Glooko

Syncing your data is the easiest way to see your full diabetes picture in one place. You can get connected in just a few minutes using either the Glooko Mobile App or your computer via the Web App.

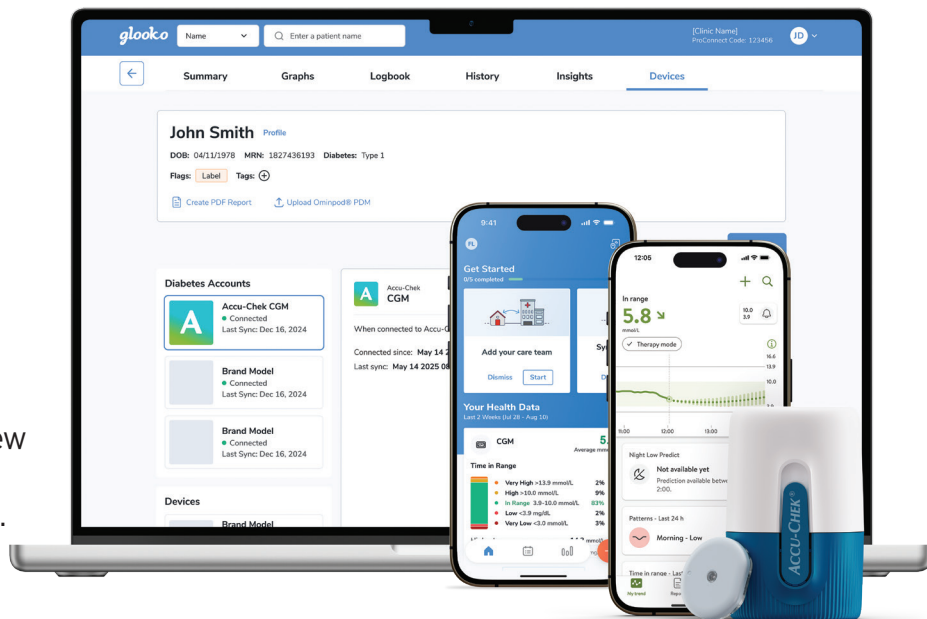

CONNECTING VIA THE GLOOKO MOBILE APP

- 1. Launch Glooko:** Open the app on your smartphone.
- 2. Add your device:** Tap the **Connected Devices** button (top-right) and select **Add Device**.
- 3. Choose your CGM:** Find and tap **Accu-Chek CGM** from the list, then click **Next**.
- 4. Sign In:** You will be redirected to the Accu-Chek portal. Enter your credentials here.

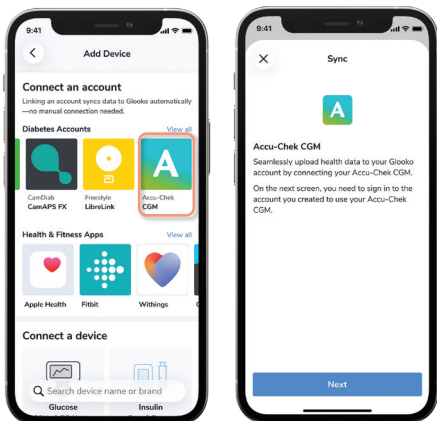

Sign in with your password

[Forgot password?](#)

- 5. On the account confirmation screen, review the consent and select **Confirm** to allow data sharing between Accu-Chek and Glooko.**
- 6. All Set!** A confirmation screen will be displayed indicating that your accounts are successfully linked.

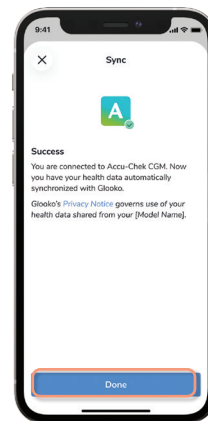

ACCU-CHEK®

glooko®
BETTER TOGETHER

CONNECTING VIA THE GLOOKO WEB APP

1. **Log In:** Head to my.glooko.com and sign in.

2. **Open Devices:** Navigate to the **Devices** tab and click **Add Device**.

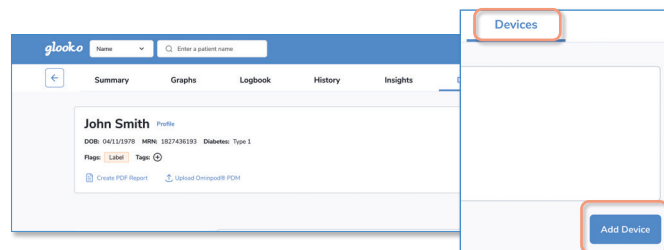

3. **Select Accu-Chek:** Find **Accu-Chek CGM** and click **Connect**.

4. **Sign In:** You will be redirected to the Accu-Chek portal in a new window or tab. Enter your credentials here.

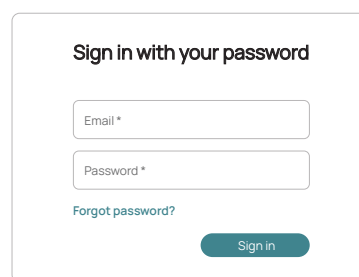
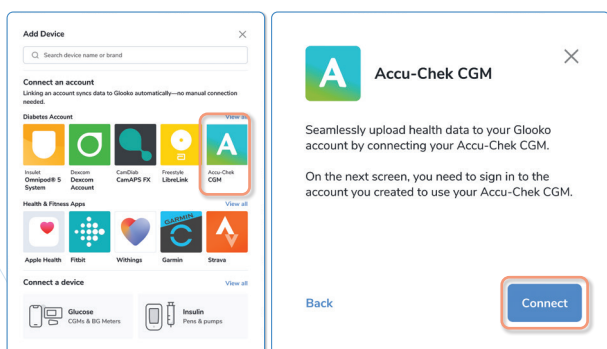

5. On the data sharing screen, review the consent and select **Confirm** to allow data sharing between Accu-Chek and Glooko.

6. **All Set!** A confirmation screen will be displayed indicating that your accounts are successfully linked.

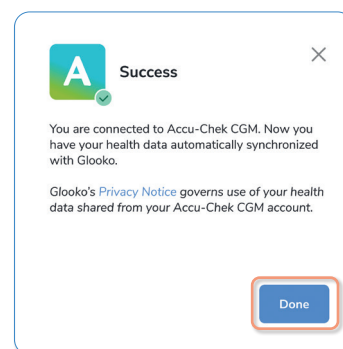

Need a hand? If you run into any issues during the linking process, our support team is ready to help at help@glooko.com.

Products and compatibility described in this document may not be available in all countries where Glooko operates. All trademarks and logos remain the property of their respective owners and are used with permission. Product appearance may vary from the images shown.